

# BALL BEARING SWIVELS

## BUILT FOR STRENGTH. DESIGNED FOR SAFETY

These tough swivels are designed to handle higher thrust loads for extra cable safety and faster straight pulls



### CAUTION

These swivels are not designed for Directional Drilling applications. They are designed for pulling cable or rope. Do not allow these swivels to be pulled around a bullwheel or capstan. Damage to the swivel and/or wheel may occur.

- Precision-machined body is made of high quality stainless steel with higher working load ratings than comparably sized swivels available on the market
- These heavy-duty swivels are built with a thrust bearing for tensile load and a radial bearing for bending load
- Working Load Limit for under ground applications is based on a horizontal pull of 3:1 while aerial applications have a WLL of 5:1
- Replacement pins available

### SWIVEL DIMENSIONS

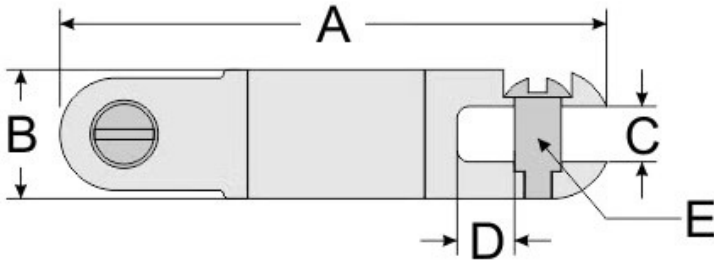

PN	A	B	C	D	E
70136 71136	3.39 in. (86.1 mm)	.86 in. (22.3 mm)	.37 in. (9.4 mm)	.38 in. (9.6 mm)	.308 in. (7.8 mm)
70137 71137	4.75 in. (120.6 mm)	1.24 in. (31.5 mm)	.53 in. (13.5 mm)	.53 in. (13.5 mm)	.399 in. (10.1 mm)
70138 71138	5.16 in. (131.0 mm)	1.36 in. (34.5 mm)	.56 in. (14.2 mm)	.51 in. (12.9 mm)	.498 in. (12.6 mm)
70139	5.96 in. (151.4 mm)	1.62 in. (41.1 mm)	.69 in. (17.5 mm)	.67 in. (17.0 mm)	.617 in. (15.7 mm)
70140	9.88 in. (250.9 mm)	2.37 in. (60.2 mm)	1.04 in. (26.4 mm)	1.15 in. (29.2 mm)	.874 in. (22.2 mm)

PN	PIN TYPE	Working Load Limit Underground	Working Load Limit Aerial	Eye Width
70136	Slot	2,250 lbs. (10.0 kN)	1,350 lbs. (6.0 kN)	3/8 in. (9.5 mm)
71136	Hex			
70137	Slot	5,000 lbs. (22.2 kN)	3,000 lbs. (13.3 kN)	17/32 in. (13.5 mm)
71137	Hex			
70138	Hex	7,000 lbs. (31.1 kN)	4,200 lbs. (18.7 kN)	9/16 in. (14.3mm)
71138	Slot			
70139	Hex	10,000 lbs.(44.5 kN)	6000 lbs. (26.7 kN)	11/16 in. (17.5mm)
70140	Hex	25,000 lbs.(111.2 kN)	15,000 lbs. (66.7 kN)	1-1/32 in. (26mm)

PN	Replacement PIN	Replacement PIN 3 Pack
70136	Slot - P/N 28039	Slot - P/N 32903
71136	Hex - P/N 33155	N/A
70137	Slot - P/N 28048	Slot - P/N 32931
71137	Hex - P/N 33156	N/A
70138	Hex - P/N 28058	Slot - P/N 32932
71138	Slot - P/N 34077	N/A
70139	Hex - P/N 28067	Hex - P/N 32933
70140	Hex - P/N 28908	Hex - P/N 32934

