

# JETSTREAM CASE FLAT-FREE WHEEL INSTALLATION

## LARGE WHEEL KIT FOR GMP JETSTREAM TRANSPORT CASE PART NUMBER 38001



a **KLEIN TOOLS**® company

GENERAL MACHINE PRODUCTS (KT), LLC  
3111 OLD LINCOLN HWY  
TREVOSÉ, PA 19053

GMPTOOLS.COM 215-357-5500

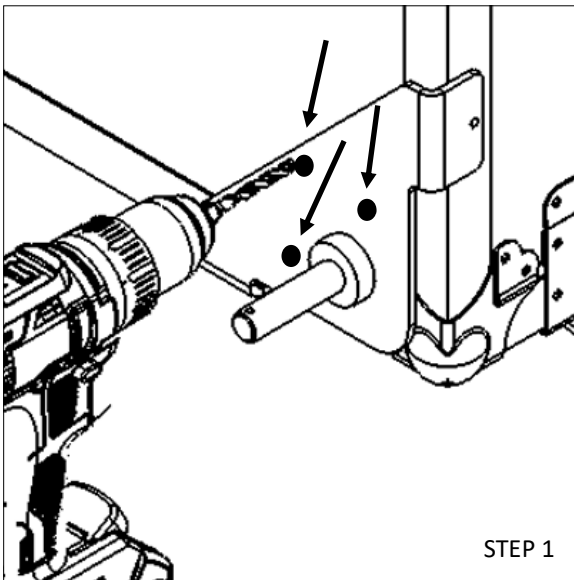

### STEP 1

PLACE BRACKET ON CORNER OF CASE  
ADJACENT TO EXISTING SMALL WHEELS.

ALIGN FLAT TABS OF BRACKET AGAINST THE  
ALUMINUM CORNER RAILS. HOLD BRACKET IN  
PLACE AND WHILE USING THE SMALLER  
SUPPLIED DRILLBIT, DRILL (3) .196 DIA. PILOT  
HOLES 1" DEEP USING THE HOLES IN THE  
BRACKET AS A GUIDE.

REPEAT ON OTHER SIDE.

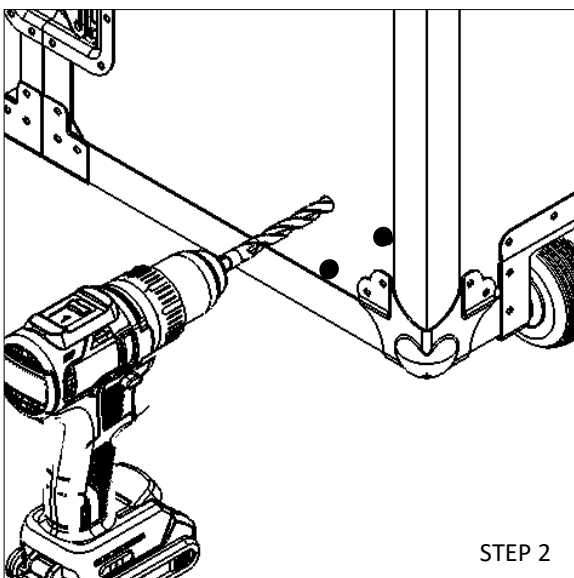

### STEP 2

REMOVE BRACKETS. USING THE .196 DIA.  
HOLES AS A GUIDE, DRILL 3/8" DIA. HOLE  
2-1/4" DEEP 3 PLACES EACH SIDE.

# JETSTREAM CASE FLAT-FREE WHEEL INSTALLATION

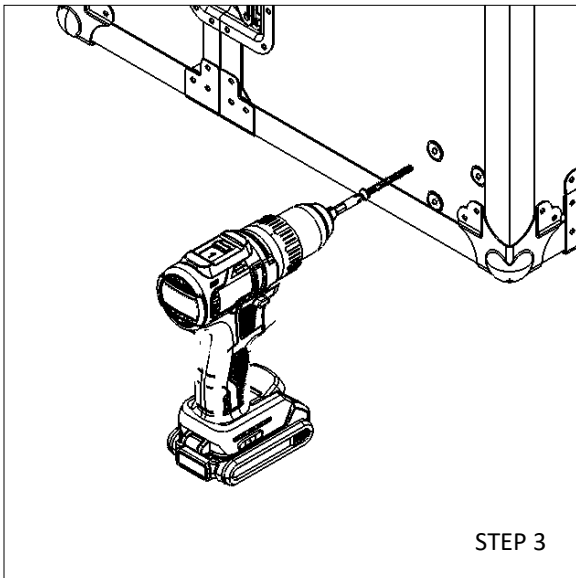

## STEP 3:

INSERT THE 3 EXPANSION ANCHORS INTO 3/8" DIA. HOLES UNTIL FLUSH. USE A HAMMER OR Mallet TO SET THE ANCHORS IN THE HOLES.

USING A CORDLESS DRILL WITH THE CLUTCH SET TO LIGHT, INSERT THE SCREW INTO THE ANCHOR UNTIL THE SCREW IS TIGHT. THIS WILL EXPAND THE ANCHOR.

REMOVE THE SCREW AND REPEAT ON THE OTHER 2 ANCHORS.

REPEAT OTHER SIDE.

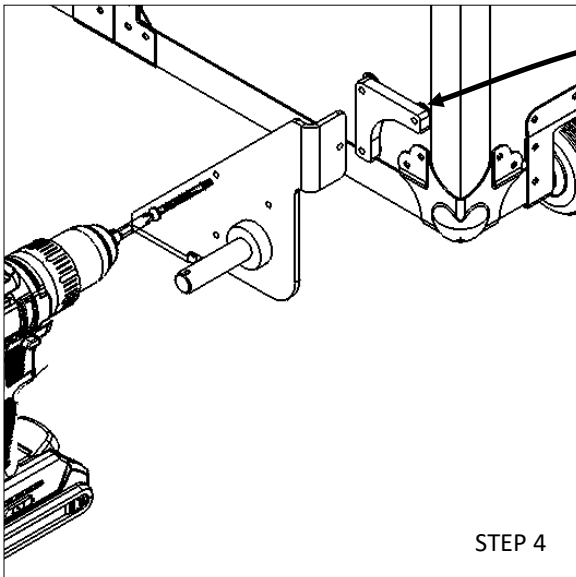

## STEP 4

PLACE THE **BRACKET SPACER** AND BRACKET ONTO THE CASE ALIGNING THE THREE HOLES IN THE BRACKET SPACER AND BRACKET WITH THE EXPANSION ANCHORS. INSERT THE EXPANSION ANCHOR SCREWS AND LOCK WASHERS INTO THE EXPANSION ANCHORS AND TIGHTEN THE 3 SCREWS ON THE BRACKET. BE CAREFUL TO NOT OVER-TORQUE THE SCREWS. USE A CLUTCH SETTING OF 6 OR 7 ON YOUR CORDLESS DRILL. REPEAT ON OTHER SIDE.

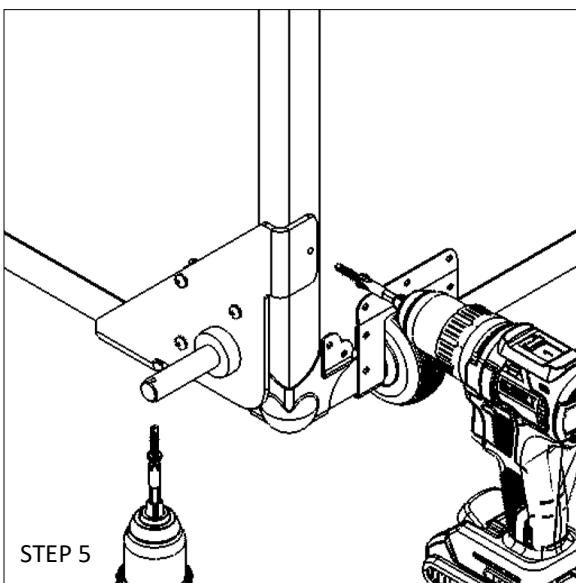

## STEP 5

SECURE THE TABS OF THE BRACKET TO THE CORNER RAILS USING THE SUPPLIED SELF TAPPING SHEET METAL SCREWS. ONE SCREW IN EACH TAB. REPEAT ON OTHER SIDE.

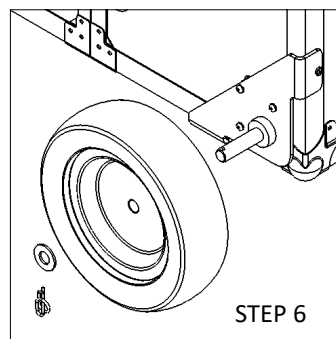

## STEP 6

PLACE THE WHEELS ON THE AXELS AND RETAIN WITH A FLAT WASHER AND LOCKING HAIR PIN CLIP.

# JETSTREAM CASE FLAT-FREE WHEEL INSTALLATION

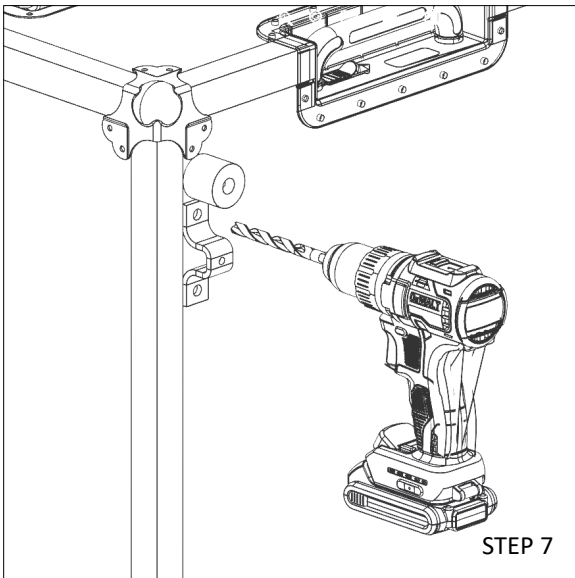

## STEP 7

USING THE BRACKET AS A TEMPLATE, PLACE IT DIRECTLY UNDER THE EXISTING FOOT. MARK AND DRILL TWO 3/8" HOLES FOR THE ANCHORS. REPEAT ON OTHER SIDE.

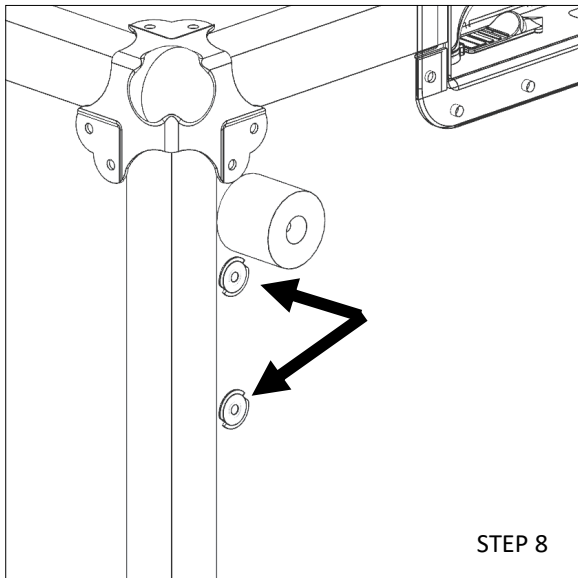
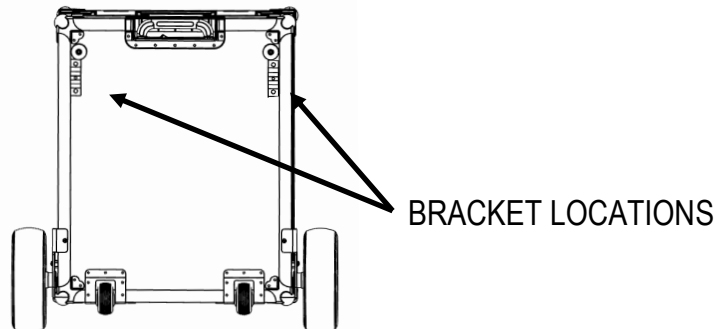

## STEP 8

INSERT THE EXPANSION ANCHORS IN THE DRILLED HOLES. USE A HAMMER OR Mallet TO SET THE ANCHORS IN THE HOLES.

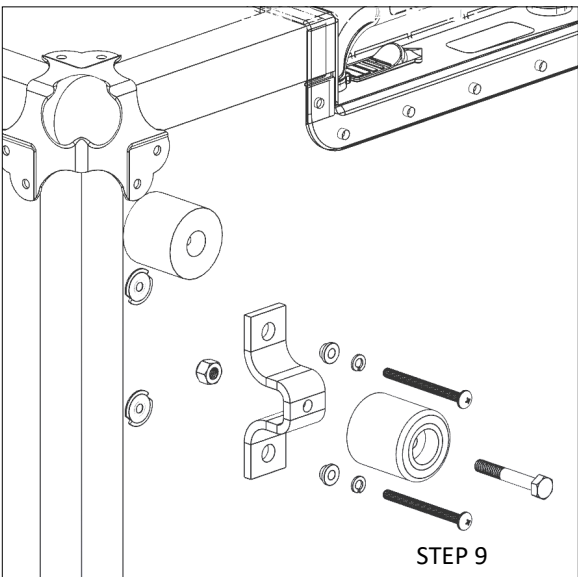

## STEP 9

1. ATTACH NEW FOOT WITH BOLT AND NUT TO BRACKET.
2. ATTACH EACH BRACKET WITH 2 SCREWS, 2 LOCK WASHERS AND 2 BUSHINGS.
3. USING A CORDLESS DRILL WITH THE CLUTCH SET TO LIGHT, INSERT THE SCREW INTO THE ANCHOR UNTIL THE SCREW IS TIGHT. THIS WILL EXPAND THE ANCHOR
4. REPEAT ON OTHER SIDE.